

ADI Technical Bulletin #16

SeaFlo 51 Series Water Pump Pressure Switch

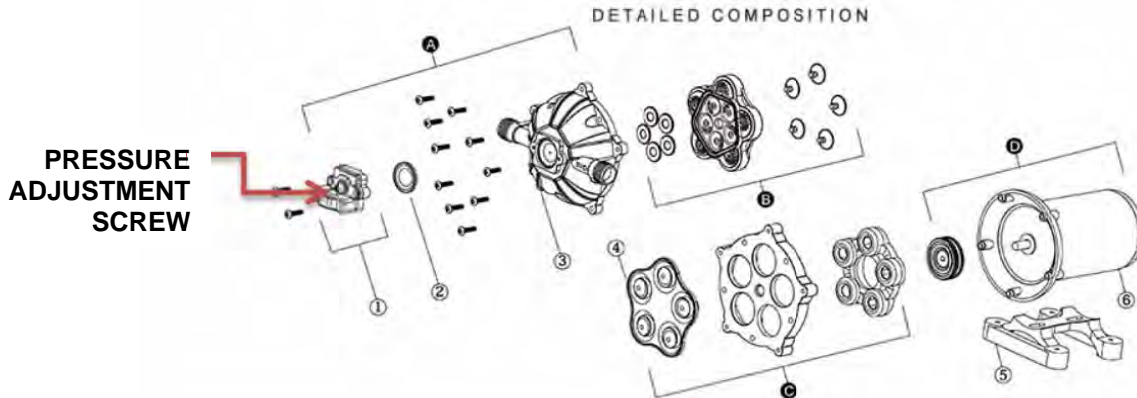

| Key | Description | Quantity |
|-----|--------------------|----------|
| A | Pump Head Assembly | 1 |
| B | Valve Assembly | 1 |
| C | Diaphragm Assembly | 1 |
| D | Motor Assembly | 1 |

| Key | Description | Quantity |
|-----|------------------------------|----------|
| 1 | Pressure switch | 1 |
| 2 | Diaphragm of Pressure Switch | 1 |
| 3 | Pump Head | 1 |
| 4 | Diaphragm | 1 |
| 5 | Rubber Feet | 1 |
| 6 | Motor | 1 |

STEP 1:

- A. Check the 12V blade fuse in the battery compartment and at the pump.
- B. If the fuse is good continue to Step #2.

STEP 2: Adjust the pressure switch on the front of the water pump:

- A. Locate the allen screw on the front of the pump.
- B. Using a 5/64" allen key, turn clockwise to increase pressure or counter-clockwise to decrease pressure.
- C. If increasing or decreasing the pressure does not work, proceed to pressure switch by-pass test.

STEP 3: Test pressure switch:

- A. Locate the red lead wire that is coming from the motor and going towards the front end where the pressure switch is.
- B. Disconnect the wire from the pressure switch and connect it directly to a power source.
- C. If the motor runs fine, the pressure switch has failed and will need to be replaced.
- D. If the motor still does not run properly, then the motor is causing the issue.
- E. Contact SeaFlo at (844)-786-7289 for Warranty Repairs & Troubleshooting

ADI Mobile Health - FACTORY

19425 SW 89th Avenue
Tualatin, OR 97062 USA
www.adi-mobilehealth.com

Phone: +1-503-885-0886
Fax: +1-503-885-0417
tech@adi-mobilehealth.com
sales@adi-mobilehealth.com